

THIS PRODUCT MANUFACTURED WITH LEAD-FREE PROCESSING

DESIGNED & DIMENSIONED IN MILLIMETERS [INCHES]

MCX7-P-C-XX-ST-CA3

GENDER
-P: PLUG

TERMINATION
-CA3: CABLE
(RG179)

TYPE
-C: CABLE

ORIENTATION
-ST: STRAIGHT

PLATING SPECIFICATION

-HN: 30μ" GOLD CENTER CONTACT,
100μ" NICKEL OUTER CONTACT
-H: 30μ" GOLD CENTER CONTACT,
3μ" GOLD OUTER CONTACT
(SEE TABLE 1)

DO NOT SCALE FROM THIS PRINT

H

TABLE 1

ITEM	COMPONENT	-HN	-H
1	SUB ASSEMBLY	SUB-MCX7-P-C-FN-ST-CA3	SUB-MCX7-P-C-F-ST-CA3
2	PIN	MCX7-P-C-H-ST-CA3-PIN	
3	OUTER FERRULE	MCX-FER-001-N	MCX-FER-001-F

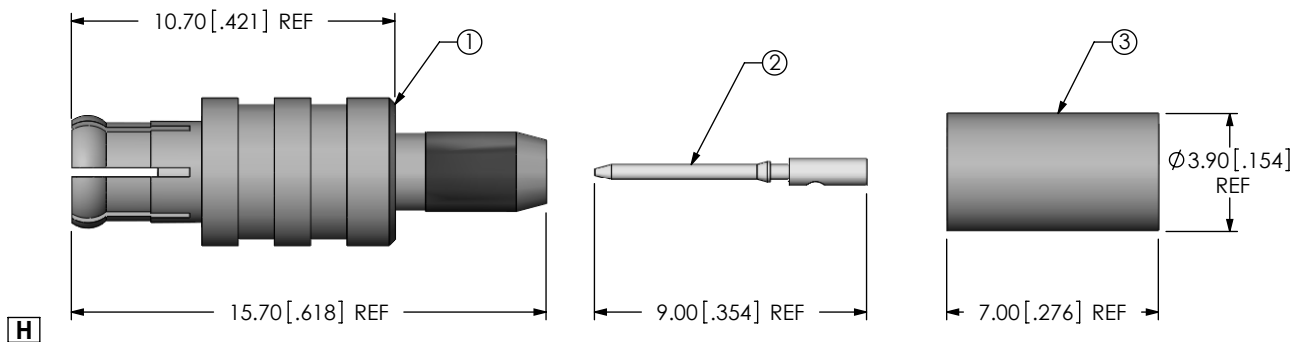

H

H NOTES:

1. C REPRESENTS A CRITICAL DIMENSION.
2. CENTER CONTACT PUSHOUT FORCE: 10 N [2.25 LB] MIN.
3. NOTE DELETED.
4. NOTE DELETED.
5. PRODUCT TO BE PACKAGED PER PACKAGING STANDARD CO-HD-WI-3040-M.
6. NOTE DELETED.
7. NOTE DELETED.
8. NOTE DELETED.

F:\DWG\MISC\MKTG\MCX7-P-C-XX-ST-CA3-MKT.SLDDRW

<p>H UNLESS OTHERWISE SPECIFIED, DIMENSIONS ARE IN MILLIMETERS [INCHES]. TOLERANCES ARE:</p> <table border="0"> <tr> <td>DECIMALS</td> <td>ANGLES</td> </tr> <tr> <td>.X: ±0.3 [.01]</td> <td>5°</td> </tr> <tr> <td>.XX: ±0.13 [.005]</td> <td></td> </tr> <tr> <td>.XXX: ±0.051 [.0020]</td> <td></td> </tr> </table>	DECIMALS	ANGLES	.X: ±0.3 [.01]	5°	.XX: ±0.13 [.005]		.XXX: ±0.051 [.0020]		<p>PROPRIETARY NOTE</p> <p>THIS DOCUMENT CONTAINS INFORMATION CONFIDENTIAL AND PROPRIETARY TO SAMTEC, INC. AND SHALL NOT BE REPRODUCED OR TRANSFERRED TO OTHER DOCUMENTS OR DISCLOSED TO OTHERS OR USED FOR ANY PURPOSE OTHER THAN THAT WHICH IT WAS OBTAINED WITHOUT THE EXPRESSED WRITTEN CONSENT OF SAMTEC, INC.</p>	<p>samtec</p> <p>520 PARK EAST BLVD. NEW ALBANY, IN 47150 PHONE: 812-944-6733 FAX: 812-948-5047 e-Mail: info@SAMTEC.com code 55322</p>
	DECIMALS	ANGLES								
.X: ±0.3 [.01]	5°									
.XX: ±0.13 [.005]										
.XXX: ±0.051 [.0020]										
<p>MATERIAL: DO NOT SCALE DRAWING SHEET SCALE: 4:1</p> <p>SHELL, FERRULES: BRASS CONTACT: BRASS DIELECTRIC: PTFE</p>	<p>DESCRIPTION: MCX STRAIGHT CABLE PLUG, RG179- 75 OHM</p> <p>DWG. NO. MCX7-P-C-XX-ST-CA3</p>									
<p>BY: R MUSSER 02/06/2008</p>		<p>SHEET 1 OF 2</p>								

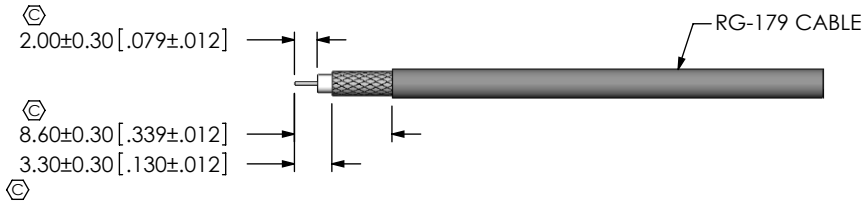

IN-PROCESS 1
STRIP AND TIN INNER
CONDUCTOR

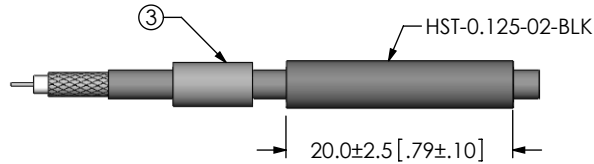

IN-PROCESS 2
ADD HEAT SHRINK TUBE
AND FERRULE

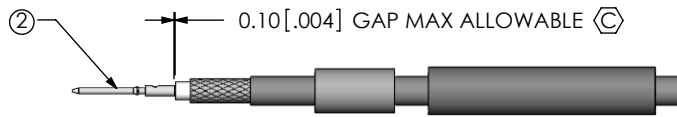

IN-PROCESS 3
SOLDER SIGNAL PIN

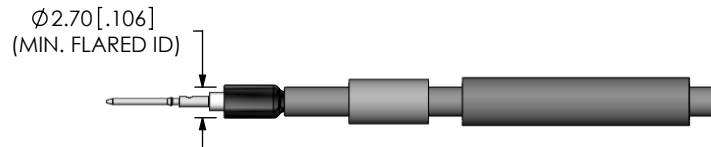

IN-PROCESS 4
FLARE SHIELD

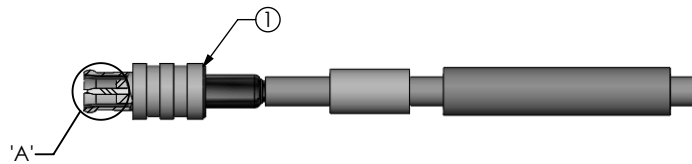

IN-PROCESS 5
ADD SUB SEEMBLY

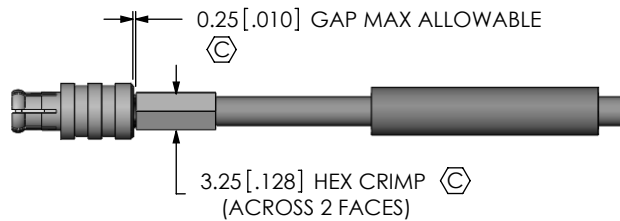

IN-PROCESS 6
CRIMP FERRULE
(USE RF CRIMP HAND
TOOL # CAT-HT-126667-21
OR EQUIVALENT)



IN-PROCESS 7
APPLY HEAT
SHRINK TUBING

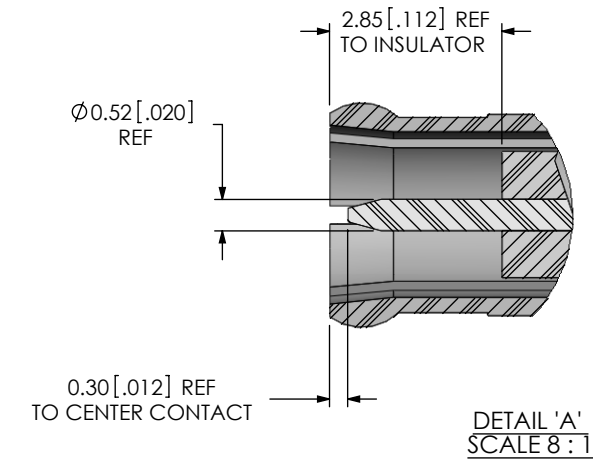

DETAIL 'A'
SCALE 8:1

PROPRIETARY NOTE

THIS DOCUMENT CONTAINS INFORMATION
CONFIDENTIAL AND PROPRIETARY TO
SAMTEC, INC., AND SHALL NOT BE REPRODUCED
OR TRANSFERRED TO OTHER DOCUMENTS OR
DISCLOSED TO OTHERS OR USED FOR ANY
PURPOSE OTHER THAN THAT WHICH IT WAS
OBTAINED WITHOUT THE EXPRESSED WRITTEN
CONSENT OF SAMTEC, INC.

DO NOT SCALE DRAWING

SHEET SCALE: 1.5:1



520 PARK EAST BLVD, NEW ALBANY, IN 47150
PHONE: 812-944-6733 FAX: 812-948-5047
e-Mail: info@SAMTEC.com code 55322

DESCRIPTION:
MCX STRAIGHT CABLE PLUG, RG179- 75 OHM

DWG. NO.
MCX7-P-C-XX-ST-CA3

BY: R MUSSER 02/06/2008 SHEET 2 OF 2