

DO NOT SCALE FROM THIS PRINT

DESIGNED & DIMENSIONED IN MILLIMETERS [INCHES]

SMA-J-C-X-ST-BR1

GENDER
-J: JACK

TYPE
-C: CABLE

TERMINATION
-BR1: REVERSED POLARITY BULKHEAD (RG174 OR RG316)

ORIENTATION
-ST: STRAIGHT

PLATING SPECIFICATION
-H: HEAVY GOLD (SEE NOTES 7 & 8)
(SMA-NUT-001-F)
(SMA-LWAS-001-F)
(SMA-PIN-005-H)
(SMA-FER-001-F)
(SUB-SMA-J-C-F-ST-BH1)

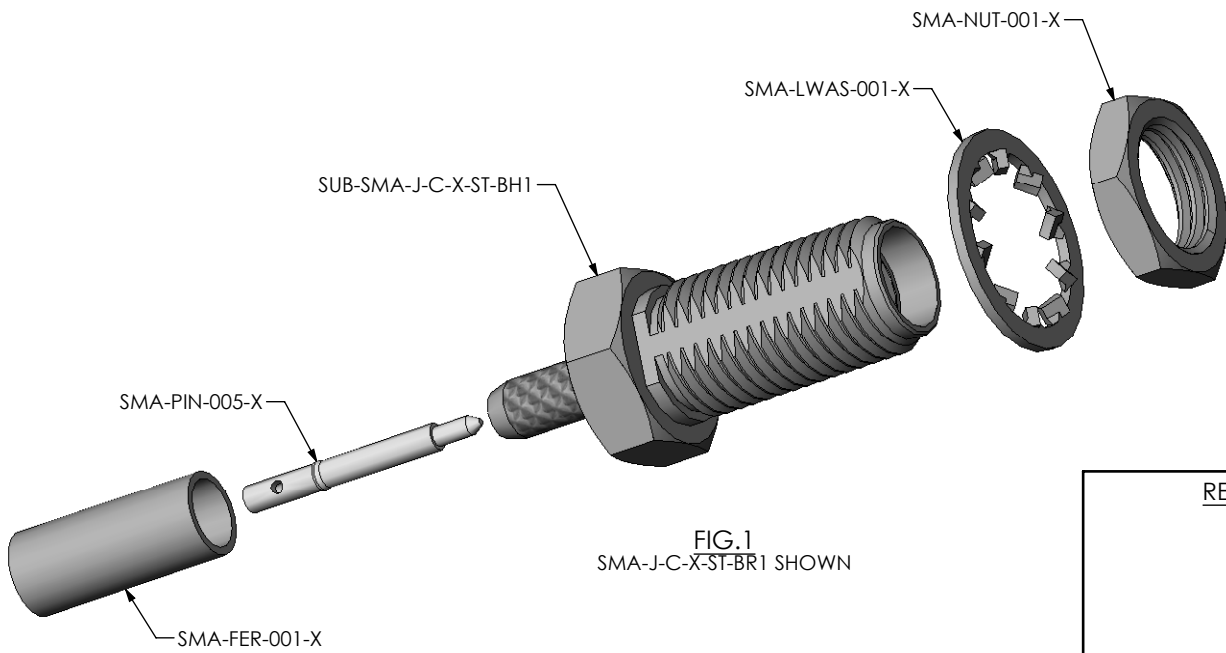
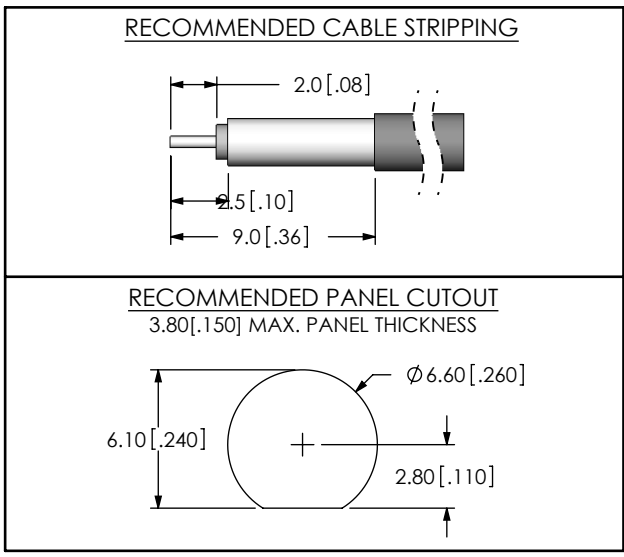

FIG.1
SMA-J-C-X-ST-BR1 SHOWN



- NOTES:
1. Ⓢ REPRESENTS A CRITICAL DIMENSION.
 2. CENTER CONTACT PUSHOUT FORCE = 26.69 N [6 LB] MIN.
 3. SEE SHEET 3 FOR TERMINATION INFORMATION.
 4. NOTE DELETED.
 5. PRODUCT TO BE PACKAGED PER PACKAGING STANDARD CO-HD-WI-3040-M.
 6. RoHS COMPLIANT.
 7. PLATING: -H: .000030" MIN GOLD OVER .000050" MIN NICKEL.
-F: .000003" MIN GOLD OVER .000050" MIN NICKEL.
 8. ASSEMBLY PLATING DESIGNATIONS:
-H: (CENTER CONTACT)-H
(OUTER CONTACT) -F
(REMAINING METAL PARTS) -F

THIS PRODUCT MANUFACTURED WITH LEAD-FREE PROCESSING

F:\DWG\MISC\MKTG\SMA-J-C-X-ST-BR1-MKT.SLDRW

UNLESS OTHERWISE SPECIFIED, DIMENSIONS ARE IN MILLIMETERS [INCHES]. TOLERANCES ARE:

| DECIMALS | ANGLES |
|----------------------|--------|
| .X: ±0.3 [.01] | 2° |
| .XX: ±0.13 [.005] | |
| .XXX: ±0.051 [.0020] | |

PROPRIETARY NOTE
THIS DOCUMENT CONTAINS INFORMATION CONFIDENTIAL AND PROPRIETARY TO SAMTEC, INC. AND SHALL NOT BE REPRODUCED OR TRANSFERRED TO OTHER DOCUMENTS OR DISCLOSED TO OTHERS OR USED FOR ANY PURPOSE OTHER THAN THAT WHICH IT WAS OBTAINED WITHOUT THE EXPRESSED WRITTEN CONSENT OF SAMTEC, INC.

520 PARK EAST BLVD., NEW ALBANY, IN 47150
PHONE: 812-944-6733 FAX: 812-948-5047
e-Mail info@SAMTEC.com code 55322

MATERIAL: DO NOT SCALE DRAWING SHEET SCALE: 1:0.333333
SHELL, FERRULE, NUT, WASHER: BRASS
CONTACT: BRASS
DIELECTRIC: PTFE

DESCRIPTION:
SMA STR JACK REV POLARITY, RG174 & RG316- 50 OHM
DWG. NO. SMA-J-C-X-ST-BR1

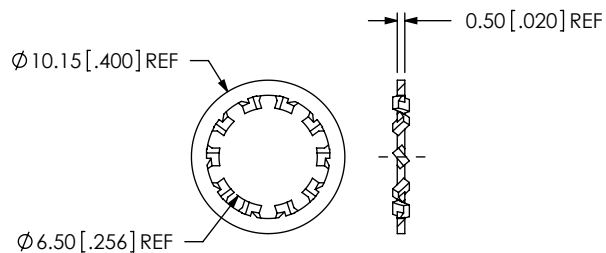

| SAMTEC PART NUMBER | ITEM |
|--------------------|-------------|
| SMA-LWAS-001-X | LOCK WASHER |

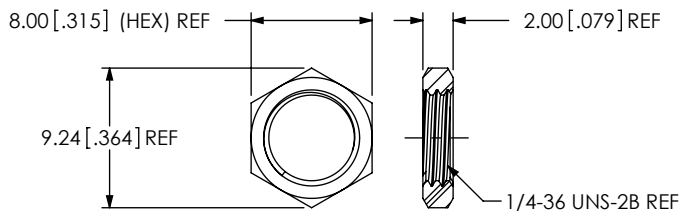

| SAMTEC PART NUMBER | ITEM |
|--------------------|---------|
| SMA-NUT-001-X | HEX NUT |

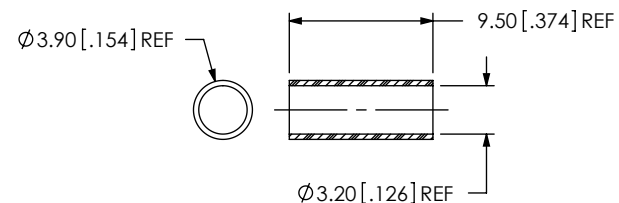

| SAMTEC PART NUMBER | ITEM |
|--------------------|---------------|
| SMA-FER-001-X | OUTER FERRULE |

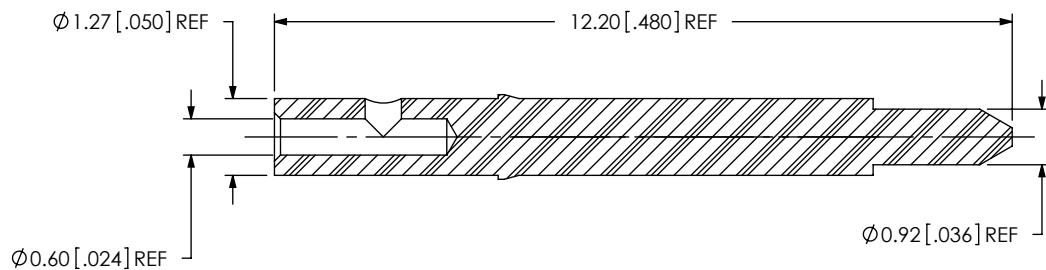

SCALE 8 : 1

| SAMTEC PART NUMBER | ITEM |
|--------------------|------|
| SMA-PIN-005-X | PIN |

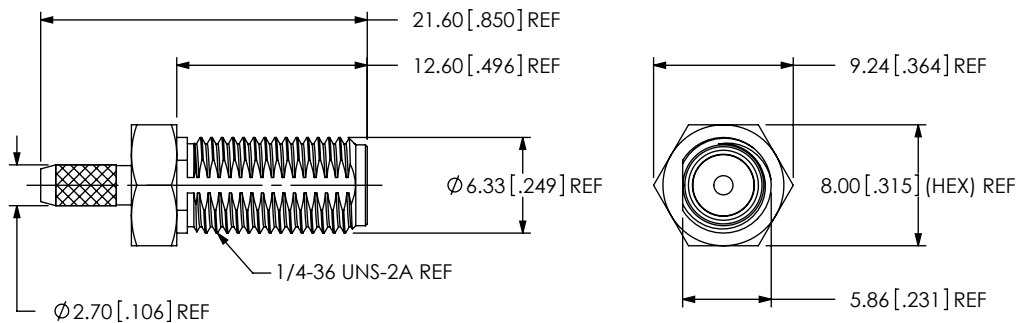

| SAMTEC PART NUMBER | ITEM |
|----------------------|--------------|
| SUB-SMA-J-C-X-ST-BH1 | SUB ASSEMBLY |

F:\DWG\MISC\MKTG\SMA-J-C-X-ST-BR1-MKT.SLDDRW

PROPRIETARY NOTE

THIS DOCUMENT CONTAINS INFORMATION CONFIDENTIAL AND PROPRIETARY TO SAMTEC, INC. AND SHALL NOT BE REPRODUCED OR TRANSFERRED TO OTHER DOCUMENTS OR DISCLOSED TO OTHERS OR USED FOR ANY PURPOSE OTHER THAN THAT WHICH IT WAS OBTAINED WITHOUT THE EXPRESSED WRITTEN CONSENT OF SAMTEC, INC.

DO NOT SCALE DRAWING

SHEET SCALE: 2:1



520 PARK EAST BLVD, NEW ALBANY, IN 47150
 PHONE: 812-944-6733 FAX: 812-948-5047
 e-Mail: info@SAMTEC.com code 55322

DESCRIPTION:
 SMA STR JACK REV POLARITY, RG174 & RG316- 50 OHM

DWG. NO. **SMA-J-C-X-ST-BR1**

BY: R MUSSER 01/28/2008 SHEET 2 OF 3

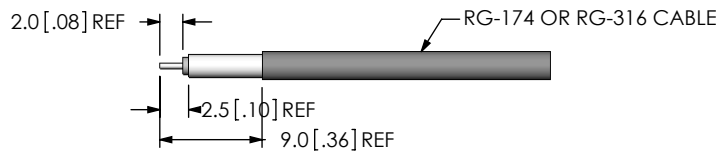

STRIP AND TIN INNER CONDUCTOR

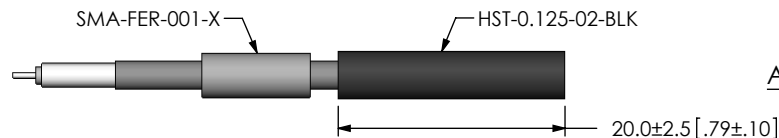

ADD HEAT SHRINK TUBE AND FERRULE

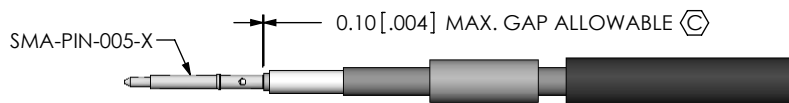

SOLDER SIGNAL PIN



FLARE SHIELD

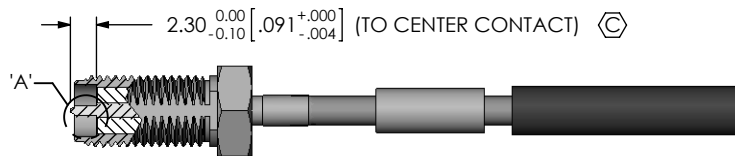

ADD SUB-SMA-J-C-X-ST-BH1

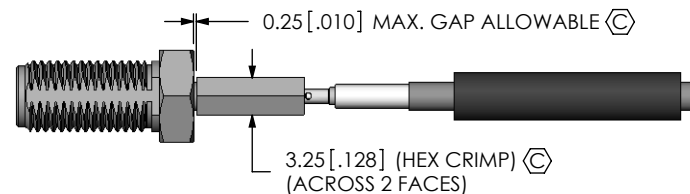

CRIMP FERRULE
(USE RF CRIMP HAND TOOL # CAT-HT-T26667-21 OR EQUIVALENT)

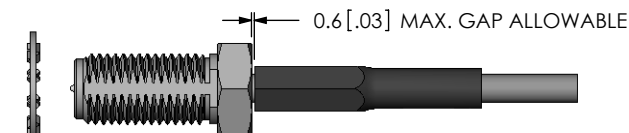

APPLY HEAT SHRINK TUBING

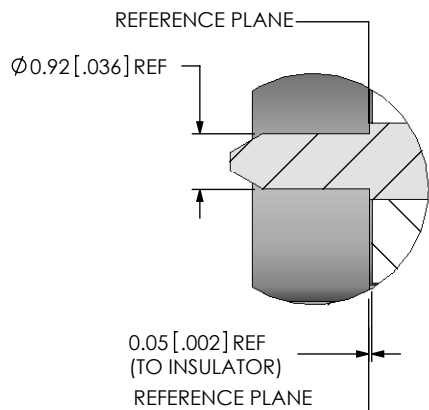
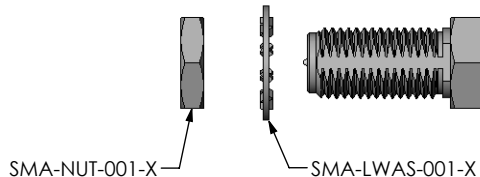

DETAIL 'A'
SCALE 8 : 1

F:\DWG\MISC\MKTG\SMA-J-C-X-ST-BR1-MKT.SLDDRW

PROPRIETARY NOTE

THIS DOCUMENT CONTAINS INFORMATION CONFIDENTIAL AND PROPRIETARY TO SAMTEC, INC. AND SHALL NOT BE REPRODUCED OR TRANSFERRED TO OTHER DOCUMENTS OR DISCLOSED TO OTHERS OR USED FOR ANY PURPOSE OTHER THAN THAT WHICH IT WAS OBTAINED WITHOUT THE EXPRESSED WRITTEN CONSENT OF SAMTEC, INC.

DO NOT SCALE DRAWING

SHEET SCALE: 1.5:1



520 PARK EAST BLVD, NEW ALBANY, IN 47150
PHONE: 812-944-6733 FAX: 812-948-5047
e-Mail info@SAMTEC.com code 55322

DESCRIPTION:
SMA STR JACK REV POLARITY, RG174 & RG316- 50 OHM

DWG. NO. SMA-J-C-X-ST-BR1

BY: R MUSSER 01/28/2008 SHEET 3 OF 3