

DESIGNED & DIMENSIONED
IN MILLIMETERS [INCHES]

SMA-P-C-X-ST-CA1

GENDER
-P: PLUG

TYPE
-C: CABLE

TERMINATION
-CA1: CABLE
(RG174 OR RG316)

ORIENTATION
-ST: STRAIGHT

PLATING SPECIFICATION
-H: HEAVY GOLD (SEE NOTES 7 & 8)
(SMA-FER-001-F)
(SMA-PIN-001-H)
(SUB-SMA-P-C-F-ST-CA1)

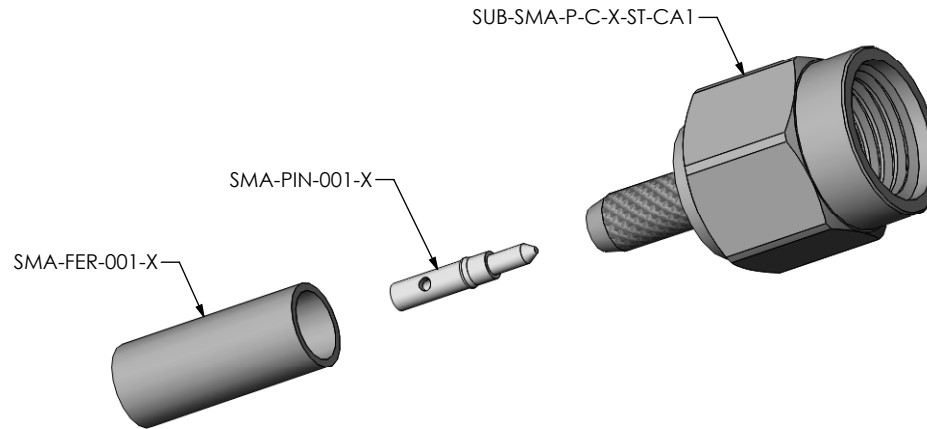
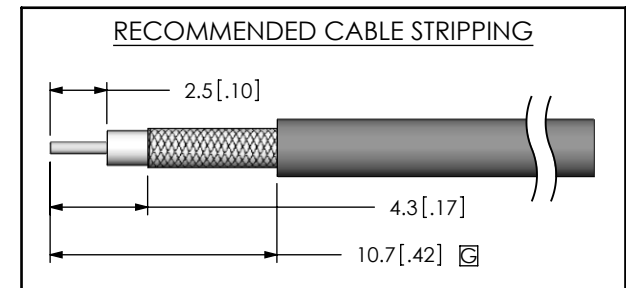

FIG.1
SMA-P-C-X-ST-CA1 SHOWN

NOTES:

1. C REPRESENTS A CRITICAL DIMENSION.
2. CENTER CONTACT PUSHOUT FORCE: 26.69 N [6 LB] MIN.
3. SEE SHEET 3 FOR TERMINATION INFORMATION.
4. DEL NOTE 4.
5. PRODUCT TO BE PACKAGED PER PACKAGING STANDARD CO-HD-WI-3040-M.
6. RoHS COMPLIANT.
7. PLATING: -F: .000003" MIN. GOLD OVER .000050" MIN. NICKEL.
-H: .000030" MIN. GOLD OVER .000050" MIN. NICKEL.
8. ASSEMBLY PLATING DESIGNATIONS:
-H: (CENTER CONTACT)-H
(OUTER CONTACT) -F
(REMAINING METAL PARTS) -F



THIS PRODUCT MANUFACTURED WITH LEAD-FREE PROCESSING

c:\enterprise\au1\DWG\MISC\MKTG\SMA-P-C-X-ST-CA1-MKT.SLDDRW

UNLESS OTHERWISE SPECIFIED, DIMENSIONS ARE IN MILLIMETERS [INCHES]. TOLERANCES ARE:

DECIMALS	ANGLES
.X: ±0.3 [.01]	2°
.XX: ±0.13 [.005]	
.XXX: ±0.051 [.0020]	

PROPRIETARY NOTE
THIS DOCUMENT CONTAINS INFORMATION CONFIDENTIAL AND PROPRIETARY TO SAMTEC, INC. AND SHALL NOT BE REPRODUCED OR TRANSFERRED TO OTHER DOCUMENTS OR DISCLOSED TO OTHERS OR USED FOR ANY PURPOSE OTHER THAN THAT WHICH IT WAS OBTAINED WITHOUT THE EXPRESSED WRITTEN CONSENT OF SAMTEC, INC.



520 PARK EAST BLVD, NEW ALBANY, IN 47150
PHONE: 812-944-6733 FAX: 812-948-5047
e-Mail: info@SAMTEC.com code: 55322

MATERIAL: DO NOT SCALE DRAWING SHEET SCALE: 1:0.333333
SHELL, FERRULE: BRASS
CONTACT: BRASS
DIELECTRIC: PTFE
GASKET: SILICONE

DESCRIPTION:
SMA STRAIGHT CABLE PLUG, RG174 & RG316- 50 OHM
DWG. NO. SMA-P-C-X-ST-CA1

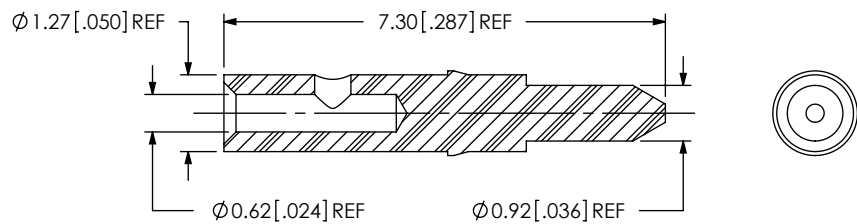

SCALE 8:1

SAMTEC PART NUMBER	ITEM
SMA-PIN-001-X	PIN

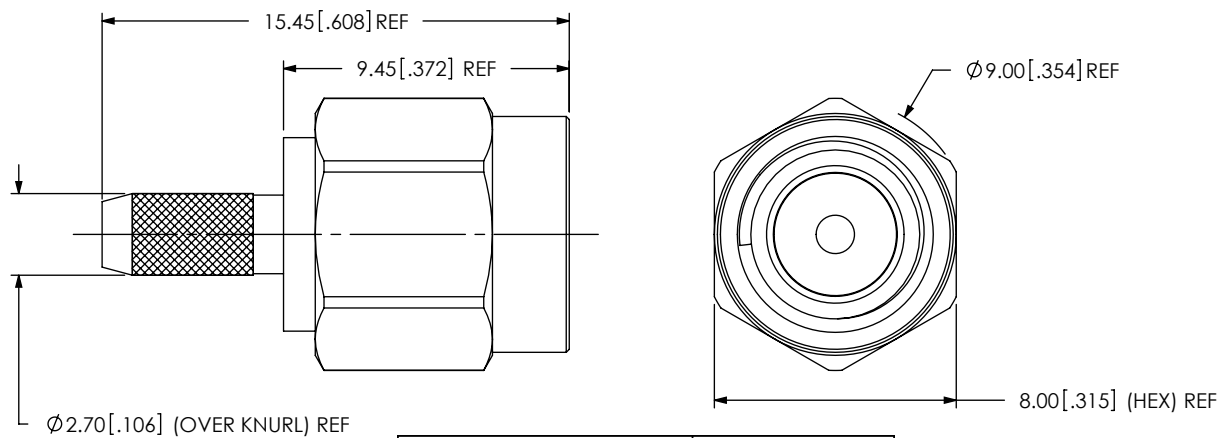

SAMTEC PART NUMBER	ITEM
SUB-SMA-P-C-X-ST-CA1	SUB ASSEMBLY

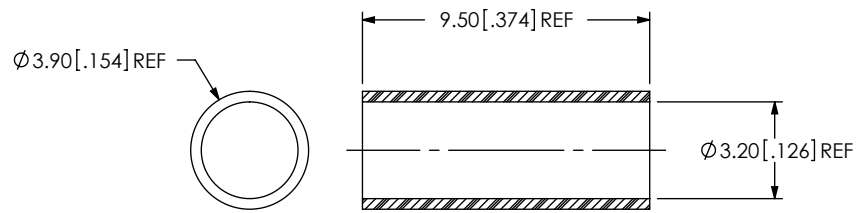

SAMTEC PART NUMBER	ITEM
SMA-FER-001-X	OUTER FERRULE

c:\enterprisevault\DWG\MISC\MKTG\SMA-P-C-X-ST-CA1-MKT.SLDDRW

PROPRIETARY NOTE
 THIS DOCUMENT CONTAINS INFORMATION CONFIDENTIAL AND PROPRIETARY TO SAMTEC, INC. AND SHALL NOT BE REPRODUCED OR TRANSFERRED TO OTHER DOCUMENTS OR DISCLOSED TO OTHERS OR USED FOR ANY PURPOSE OTHER THAN THAT WHICH IT WAS OBTAINED WITHOUT THE EXPRESSED WRITTEN CONSENT OF SAMTEC, INC.

DO NOT SCALE DRAWING

SHEET SCALE: 4:1



520 PARK EAST BLVD, NEW ALBANY, IN 47150
 PHONE: 812-944-6733 FAX: 812-948-5047
 e-Mail: info@SAMTEC.com code: 55322

DESCRIPTION:
 SMA STRAIGHT CABLE PLUG, RG174 & RG316- 50 OHM

DWG. NO. **SMA-P-C-X-ST-CA1**

BY: R MUSSER 01/22/2008 SHEET 2 OF 3

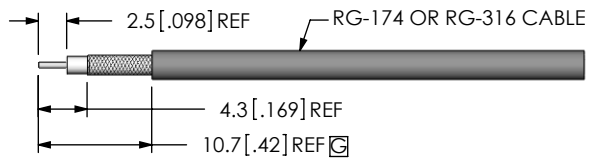

STRIP AND TIN INNER CONDUCTOR

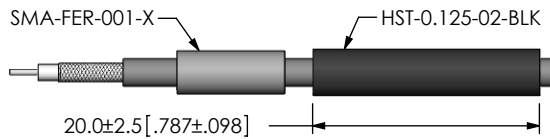

ADD HEAT SHRINK TUBE AND FERRULE

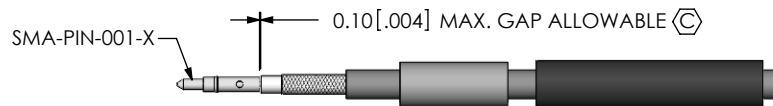

SOLDER SIGNAL PIN

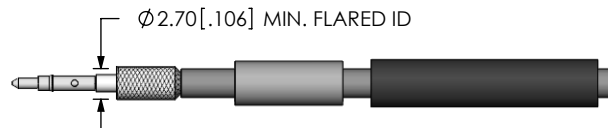

FLARE SHIELD

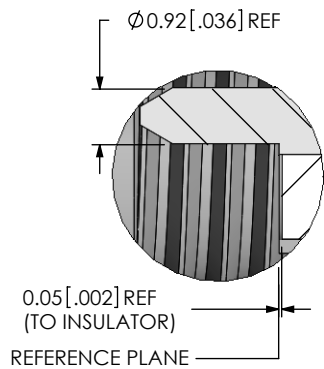

DETAIL 'A'
SCALE 8 : 1

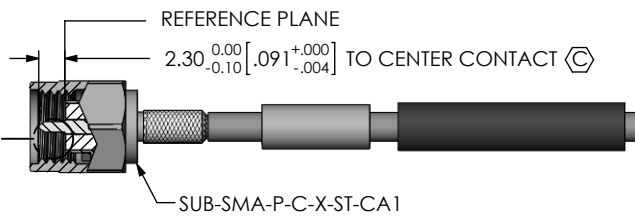

ADD SUB-SMA-P-C-X-ST-CA1

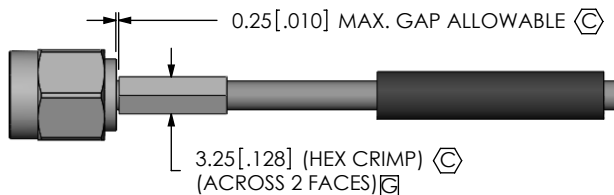

CRIMP FERRULE
(USE RF CRIMP HAND TOOL # CAT-HT-126667-21 OR EQUIVALENT)

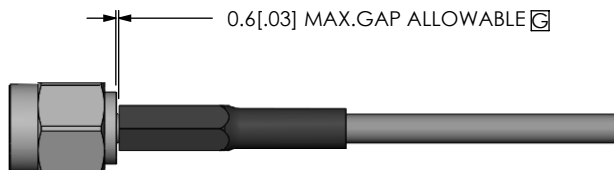

APPLY HEAT SHRINK TUBING

c:\enterprisevault\DWG\MISC\MKTG\SMA-P-C-X-ST-CA1-MKT.SLDDRW

PROPRIETARY NOTE

THIS DOCUMENT CONTAINS INFORMATION CONFIDENTIAL AND PROPRIETARY TO SAMTEC, INC. AND SHALL NOT BE REPRODUCED OR TRANSFERRED TO OTHER DOCUMENTS OR DISCLOSED TO OTHERS OR USED FOR ANY PURPOSE OTHER THAN THAT WHICH IT WAS OBTAINED WITHOUT THE EXPRESSED WRITTEN CONSENT OF SAMTEC, INC.

DO NOT SCALE DRAWING

SHEET SCALE: 1.5:1



520 PARK EAST BLVD, NEW ALBANY, IN 47150
PHONE: 812-944-6733 FAX: 812-948-5047
e-Mail: info@SAMTEC.com code: 55322

DESCRIPTION:
SMA STRAIGHT CABLE PLUG, RG174 & RG316- 50 OHM

DWG. NO. **SMA-P-C-X-ST-CA1**

BY: R MUSSER 01/22/2008 SHEET 3 OF 3