

DO NOT SCALE FROM THIS PRINT

DESIGNED & DIMENSIONED IN MILLIMETERS [INCHES]

SMB5-P-C-XX-ST-CA1

GENDER -P:PLUG

TYPE -C:CABLE

TERMINATION -CA1:CABLE (RG174 OR RG316)

ORIENTATION -ST:STRAIGHT

PLATING

-HN: HEAVY GOLD/NICKEL (SEE NOTE 7 & 8) (MCX-FER-001-N) (SMB5-SKT-001-H) (SUB-SMB5-P-C-FN-ST-CA1)

-H: HEAVY GOLD (SEE NOTE 7 & 8) (MCX-FER-001-F) (SMB5-SKT-001-H) (SUB-SMB5-P-C-F-ST-CA1)

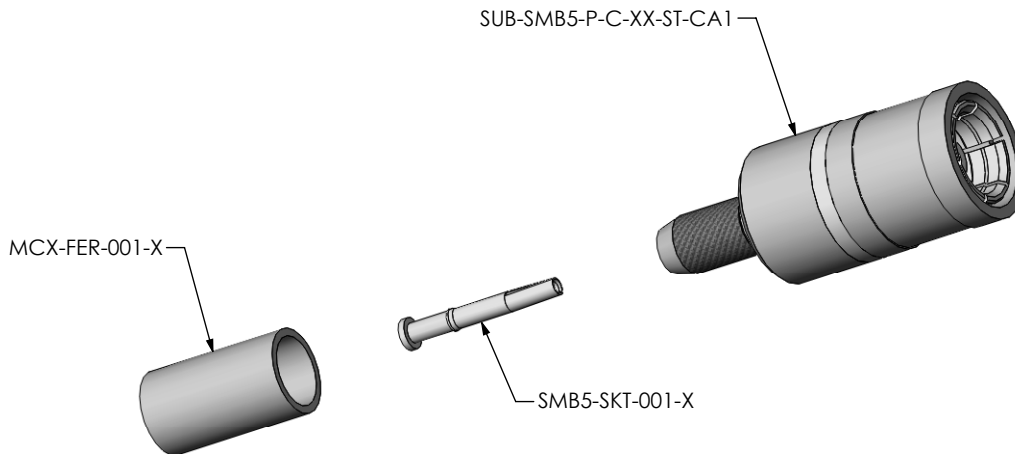
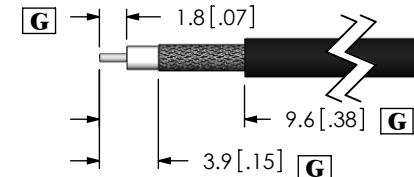

FIG. 1
SMB5-P-C-XX-ST-CA1 SHOWN

NOTES:

- ⊕ REPRESENTS A CRITICAL DIMENSION.
- PUSHOUT FORCE FOR CENTER CONTACT: 17.79 N [4.0 LB] MIN.
- SEE SHEET 3 FOR TERMINATION INFORMATION.
- NOTE DELETED.
- PRODUCT TO BE PACKAGED PER PACKAGING STANDARD CO-HD-WI-3040-M.
- RoHS COMPLIANT.
- PLATING: -N: .000100" MIN. NICKEL.
-H: .000030" MIN. GOLD OVER .000050" MIN. NICKEL.
-F: .000003" MIN. GOLD OVER .000050" MIN. NICKEL.
- ASSEMBLY PLATING DESIGNATIONS:
-HN: (CENTER CONTACT)-H:
(OUTER CONTACT) -F:
(REMAINING METAL PARTS) -N:
-H: (CENTER CONTACT) -H:
(OUTER CONTACT) -F:
(REMAINING METAL PARTS) -F:

RECOMMENDED CABLE STRIPPING



THIS PRODUCT MANUFACTURED WITH LEAD-FREE PROCESSING

UNLESS OTHERWISE SPECIFIED, DIMENSIONS ARE IN MILLIMETERS [INCHES]. TOLERANCES ARE:

| DECIMALS | ANGLES |
|----------------------|--------|
| .X: ±0.3 [.01] | 2° |
| .XX: ±0.13 [.005] | |
| .XXX: ±0.051 [.0020] | |

PROPRIETARY NOTE
THIS DOCUMENT CONTAINS INFORMATION CONFIDENTIAL AND PROPRIETARY TO SAMTEC, INC. AND SHALL NOT BE REPRODUCED OR TRANSFERRED TO OTHER DOCUMENTS OR DISCLOSED TO OTHERS OR USED FOR ANY PURPOSE OTHER THAN THAT WHICH IT WAS OBTAINED WITHOUT THE EXPRESSED WRITTEN CONSENT OF SAMTEC, INC.

MATERIAL: DO NOT SCALE DRAWING SHEET SCALE: 3:1
SHELL, FERRULE: BRASS
CONTACT: COPPER ALLOY
DIELECTRIC: PTFE

samtec

520 PARK EAST BLVD, NEW ALBANY, IN 47150
PHONE: 812-944-6733 FAX: 812-948-5047
e-Mail: info@SAMTEC.com code: 53322

DESCRIPTION:
SMB5 STRAIGHT CABLE PLUG, RG174 & RG316 - 50 OHM

DWG. NO.
SMB5-P-C-XX-ST-CA1

BY: G.HERMAN 12/07/2007 SHEET 1 OF 3

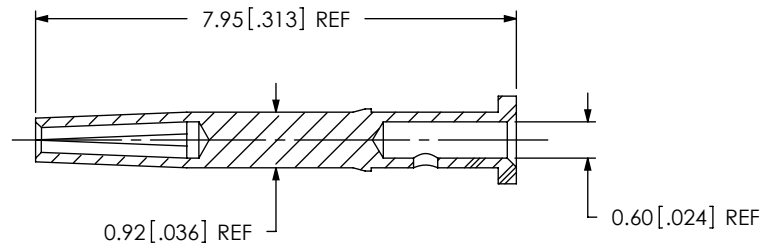
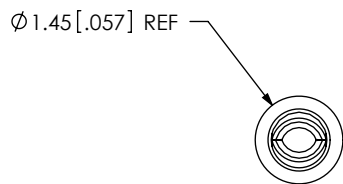

SCALE 8:1

| SAMTEC PART NUMBER | ITEM |
|--------------------|--------|
| SMB5-SKT-001-X | SOCKET |

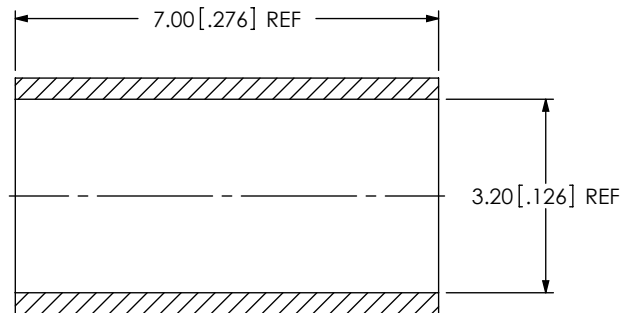
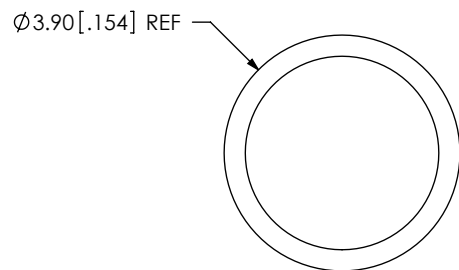

SCALE 8:1

| SAMTEC PART NUMBER | ITEM |
|--------------------|---------------|
| MCX-FER-001-X | OUTER FERRULE |

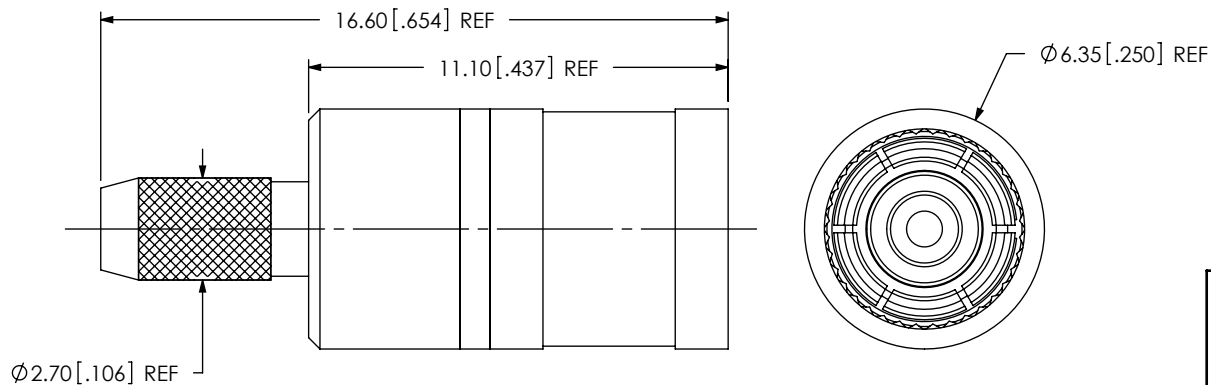

F:\DWG\MISC\MKTG\SMB5-P-C-XX-ST-CA1-MKT.SLDDRW

PROPRIETARY NOTE
 THIS DOCUMENT CONTAINS INFORMATION
 CONFIDENTIAL AND PROPRIETARY TO
 SAMTEC, INC. AND SHALL NOT BE REPRODUCED
 OR TRANSFERRED TO OTHER DOCUMENTS OR
 DISCLOSED TO OTHERS OR USED FOR ANY
 PURPOSE OTHER THAN THAT WHICH IT WAS
 OBTAINED WITHOUT THE EXPRESSED WRITTEN
 CONSENT OF SAMTEC, INC.



520 PARK EAST BLVD, NEW ALBANY, IN 47150
 PHONE: 812-944-6733 FAX: 812-948-5047
 e-Mail: info@SAMTEC.com code: 55322

DO NOT SCALE DRAWING

SHEET SCALE: 5:1

DESCRIPTION:
 SMB5 STRAIGHT CABLE PLUG, RG174 & RG316 - 50 OHM

DWG. NO.
SMB5-P-C-XX-ST-CA1

BY: G.HERMAN 12/07/2007 SHEET 2 OF 3

| SAMTEC PART NUMBER | ITEM |
|------------------------|--------------|
| SUB-BNC5-P-C-XX-ST-CA1 | SUB ASSEMBLY |

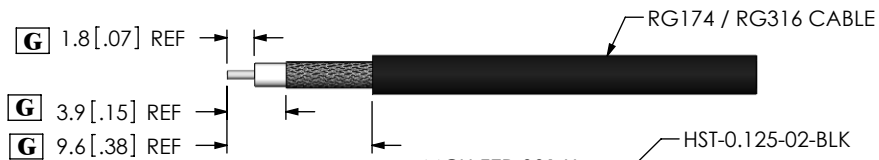

STRIP AND TIN INNER CONDUCTOR

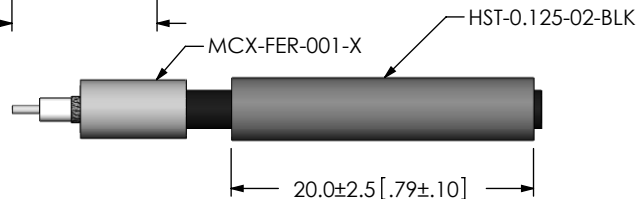

ADD HEAT SHRINK TUBE AND FERRULE

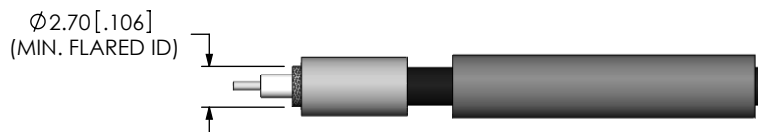

FLARE SHIELD

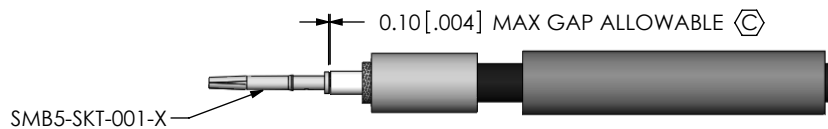

SOLDER SIGNAL SOCKET

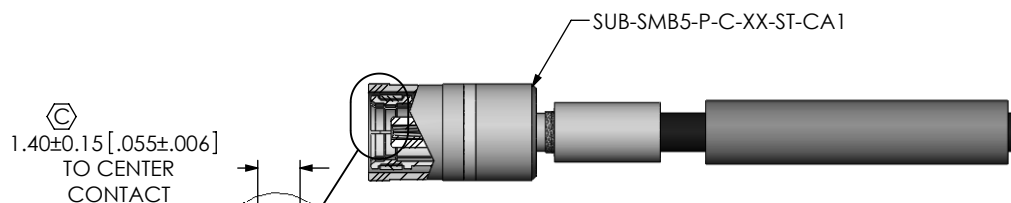

ADD SUB-SMB5-P-C-XX-ST-CA1

DETAIL 'A'
SCALE 4:1

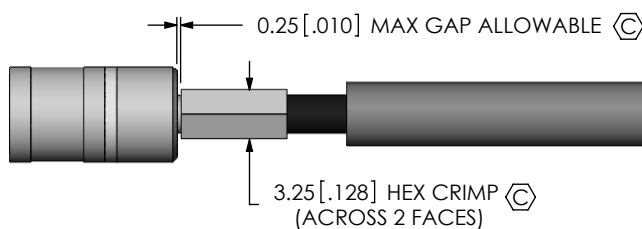

CRIMP FERRULE
(USE RF CRIMP HAND TOOL #CAT-HT-126667-21 OR EQUIVALENT)

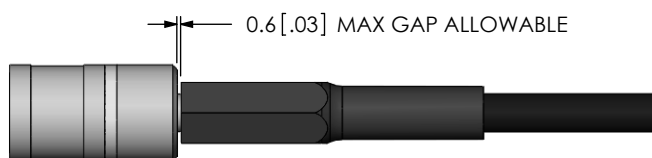

APPLY HEAT SHRINK TUBE

F:\DWG\MISC\MKTG\SMB5-P-C-XX-ST-CA1-MKT.SLDDRW

| | | | |
|-----------------------------------------------------|-----------------------------------------------------------------------------------------------------------------------------------------------------------------------------------------------------------------------------------------------------------------------------------------------------------------------------|--|--------------------------------------------------------------------------------------------------------------------------------------------------------|
| <p>DO NOT SCALE DRAWING</p> <p>SHEET SCALE: 2:1</p> | <p>PROPRIETARY NOTE THIS DOCUMENT CONTAINS INFORMATION CONFIDENTIAL AND PROPRIETARY TO SAMTEC, INC. AND SHALL NOT BE REPRODUCED OR TRANSFERRED TO OTHER DOCUMENTS OR DISCLOSED TO OTHERS OR USED FOR ANY PURPOSE OTHER THAN THAT WHICH IT WAS OBTAINED WITHOUT THE EXPRESSED WRITTEN CONSENT OF SAMTEC, INC.</p> | | <p>samtec</p> <p>520 PARK EAST BLVD, NEW ALBANY, IN 47150 PHONE: 812-944-6733 FAX: 812-948-5047 e-Mail: info@SAMTEC.com code: 55322</p> |
| | <p>DESCRIPTION: SMB5 STRAIGHT CABLE PLUG, RG174 & RG316 - 50 OHM</p> | | |
| | <p>DWG. NO. SMB5-P-C-XX-ST-CA1</p> | | <p>BY: G.HERMAN 12/07/2007</p> |